

SAPPHIRE



GearBox 500

The GearBox 500 Thunderbolt™ 3 eGFX enclosure enables users to convert a Thunderbolt™ 3 / 4 Mac or Windows 10 device into a powerful productivity and gaming desktop. The enclosure features a lightning quick 40Gbps Thunderbolt™ 3 connecting interface that handles various types of data and is capable of charging a Thunderbolt™ 3 / 4 configured laptop.

Thunderbolt™ 3 eGFX Enclosure

Light, Slim and Portable



138mm (5.43")

300mm (11.8")

204mm (8.03")

Diverse Outputs



USB 3.0 x2

Thunderbolt™ 3 with 60W PD

Gigabit Ethernet

Not Only Graphics Cards but also other types of PCI-E Devices.



x16 PCIe 3.0 Slot

Win
OS

mac
OS

Compatible with Windows and macOS

Performance to Rule Your Game



Better Performance When Playing with the SAPHIRE GearBox 500 with PULSE RX 6600 XT

Gaming Performance Benchmarks Average FPS

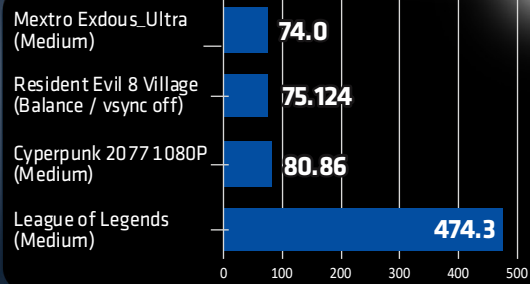

Industry Benchmarks: With / Without SAPHIRE GearBox 500 with PULSE RX 6600 XT

3D Mark Standard Preset Benchmark

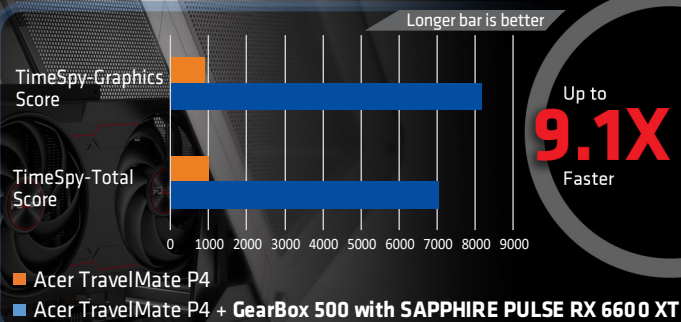

3D Mark Standard Preset Benchmark

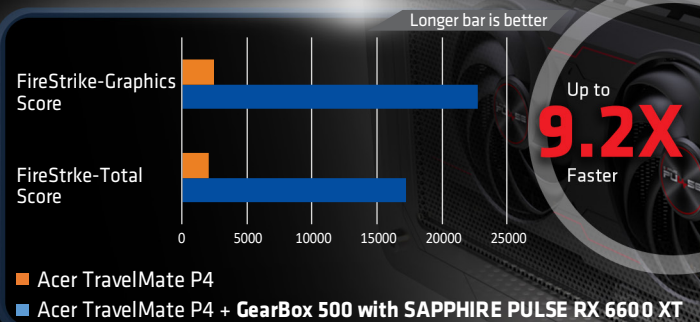

GFXBench 5.0 1080P Aztec Ruins

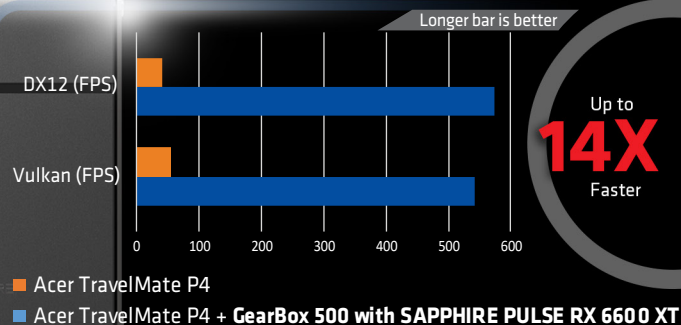

SAPHIRE

Experience Desktop-Class Graphics Power with the GearBox 500 eGPU Enclosure

Industry Benchmarks: With / Without SAPHIRE GearBox 500 with PULSE RX 6600 XT

3D Mark Standard Preset Benchmark

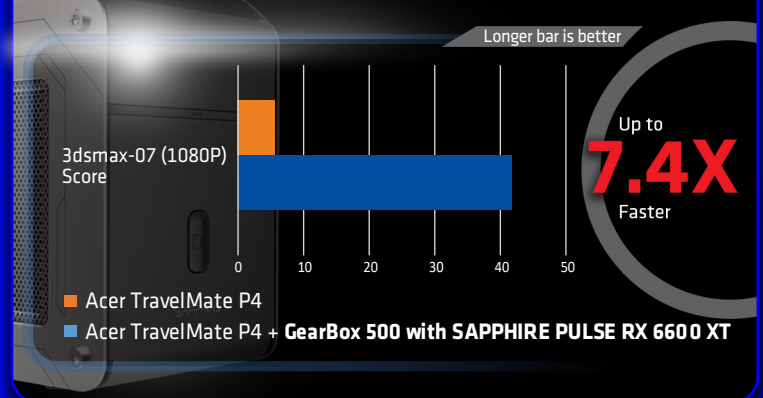

Video Editing Benchmark

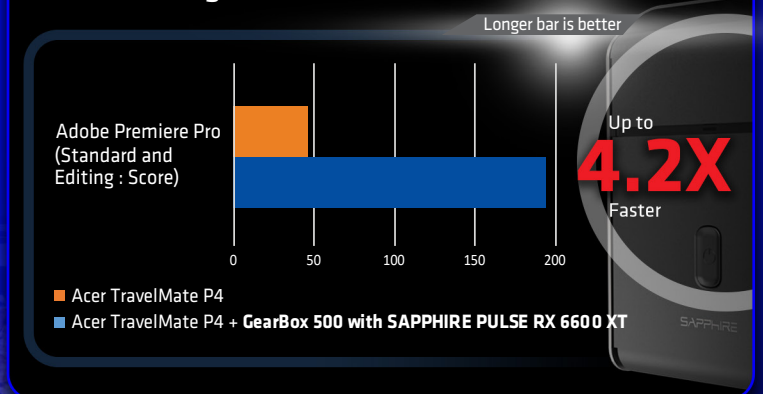

Rendering Benchmark Real Model Rendering Time

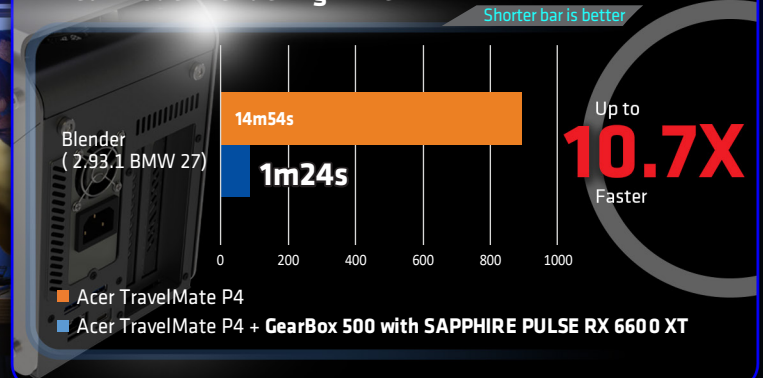

Simple Set up to Boost Performance

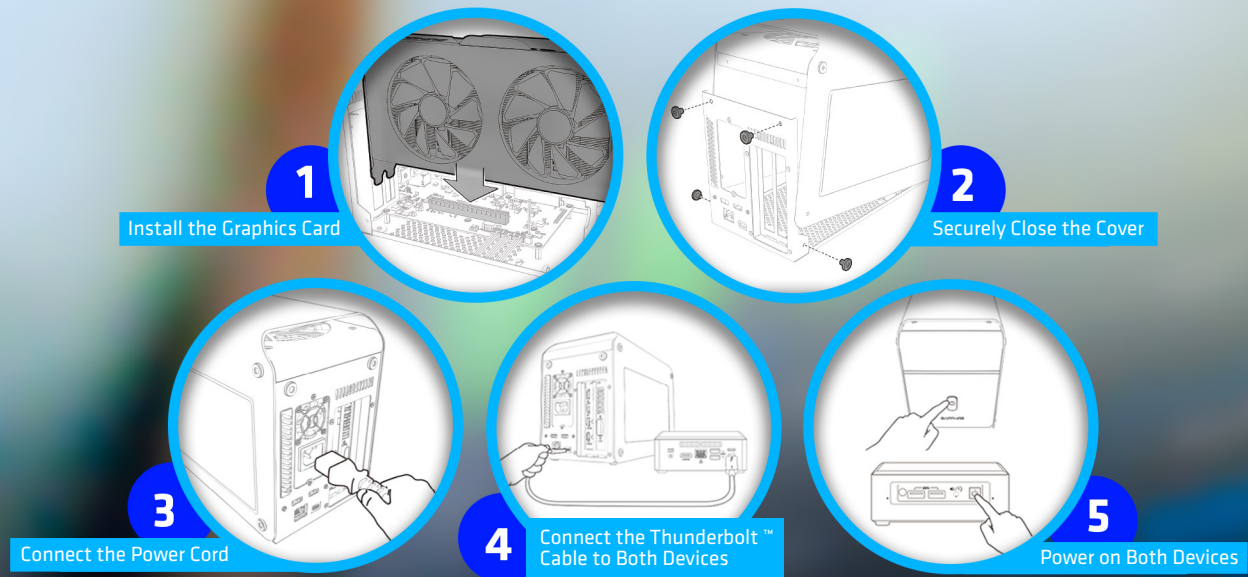

Compatible with both AMD and Nvidia Graphics Cards

****Max Dimension: 266 mm (L) x 125 mm (H) / 10.5" (L) x 4.9" (H)**

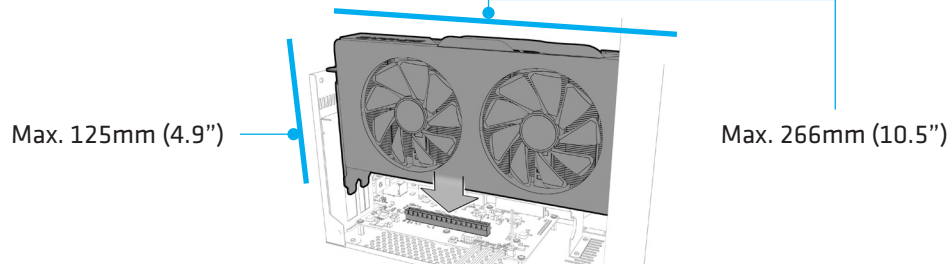

AMD Radeon Graphics Series*	AMD RADEON RX 6700 XT AMD RADEON RX 6600 XT AMD RADEON RX 6600 AMD RADEON RX 5700 XT AMD RADEON RX 5700 AMD RADEON RX 5600 XT	AMD RADEON RX 5500 XT AMD RADEON VII AMD RADEON RX 590 AMD RADEON RX Vega 56 ITX AMD RADEON RX 580 AMD RADEON RX 570
	AMD Radeon Graphics Series*	AMD Radeon Pro WX 7100
NVIDIA GeForce Graphics Series*	NVIDIA GeForce RTX 3060 NVIDIA GeForce RTX 3060Ti NVIDIA GeForce RTX 2060 NVIDIA GeForce RTX 2070	NVIDIA GeForce GTX 1080 NVIDIA GeForce GTX 1070 NVIDIA GeForce GTX 1060 NVIDIA GeForce Titan X
	NVIDIA Quadro GPU Solutions *	NVIDIA Quadro P4000

*Graphics cards use varied designs based around a common graphics chip. Please ensure the GPU selected meets all size, power, and additional requirements.

*Install the Graphics card in the SAPHIRE GearBox and connect to your system.

*Download and install the driver software. Go to the AMD or NVIDIA website to find the appropriate graphics driver for your system.

SAPHIRE GearBox 500 Thunderbolt™ 3 eGFX Enclosure Specifications

Connect to PC	Thunderbolt™ 3/4 using 40Gbps Cable / Power Delivery up to 60 Watts
GPU Support	GPU Type: Single / Double Slot, Full Length, PCI-Express x16 Graphics Cards GPU Max. Power support: 350 Watts
Graphics Outputs	Depends on the capabilities of installed graphics card
PCI-Express Bus	PCI-Express 3.0 x16 in x4 mode
Input	Thunderbolt™ 3 / 4 (USB-C for connection to PC)
Output	2 x USB 3.0 Gigabit Ethernet 10/100/1000
Internal Power Supply	500 Watts
Operating Systems	Apple macOS Monterey 12.1 or later Windows 10 64-bit / Windows 11 64-bit *32-bit Windows 10/11, Windows 7 and Linux are not supported.



Copyright© 2021 SAPHIRE Technology LTD. SAPHIRE, the SAPHIRE logo and combinations thereof are trademarks of SAPHIRE Technology, LTD. ©AMD, and the AMD Arrow logo, FreeSync, Radeon, RDNA, and combinations thereof are trademarks of Advanced Micro Devices, Inc. DirectX and Microsoft are registered trademarks of Microsoft Corporation in the US and other jurisdictions. PCI Express is a registered trademark of PCI-SIG Corporation. HDMI, the HDMI logo and High-Definition Multimedia Interface are trademarks or registered trademarks of HDMI Licensing, LLC in the United States and other countries. Vulkan and the Vulkan logo are trademarks of the Khronos Group Inc. Feature, performance and product specifications may vary by operating environment and are subject to change without notice. Products may not be exactly as shown.