

# DEFINING RUGGED

EXCEPTIONAL ENGINEERING | ROCK SOLID | EXTENSIVE TESTING

## UNIVERSAL HORIZONTAL SURFACE BASE

Placement	Seat Configurations	Drilling Required	Pole	Weight	Height	Width	Depth
Flat, horizontal surface	All	Yes	NA - attaches to <b>Motion Attachment</b>	2 lbs	0.75"	6.0"	6.0"

### Features:

- Heavy gauge steel construction for long-term durability
- Black powdercoat finish for maximum corrosion resistance
- Solution for any vehicle where mounting floor space is limited
- Provides low rise for mounting on storage boxes or engine covers

Item No. **DS-56**

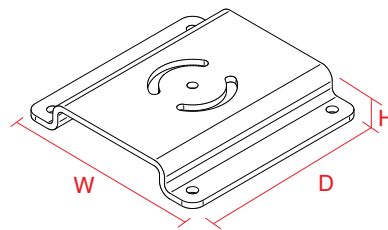

3001 Borham Ave. | Stevens Point, WI 54481, USA  
Phone: 715.344-3482 | Toll-free: 800.487-9220 | Fax: 715.344-5209  
Email: [gamberj@gamberjohnson.com](mailto:gamberj@gamberjohnson.com) | Website: [www.gamberjohnson.com](http://www.gamberjohnson.com)

This document, including images, may not be reproduced partly or fully without the expressed written consent of Gamber-Johnson's Marketing Department. © Copyright 2012 Gamber-Johnson LLC